

RED LASER DIODE

DL-LS1148

Tentative

SANYO

Ver.2 May. 2005

Features

- Short wavelength : 638 nm (Typ.)
- High output power : 40 mW (CW)
- Low threshold current : $I_{th} = 65$ mA (Typ.)
- Low operating voltage : $V_{op} = 2.4$ V (Typ.)

Applications

Bar-code scanner
Line marker , Leveler
Laser display

Absolute Maximum Ratings

 $(T_c=25^\circ\text{C})$

Parameter		Symbol	Ratings	Unit
Light Output	CW	P_o (CW)	40	mW
Reverse Voltage	Laser	VR	2	V
	PD		30	
Operating Temperature		T_{opr}	-10 to +50	$^\circ\text{C}$
Storage Temperature		T_{stg}	-40 to +85	$^\circ\text{C}$

Electrical and Optical Characteristics ^{1) 2)}

 $(T_c=25^\circ\text{C})$

Parameter		Symbol	Condition	Min.	Typ.	Max.	Unit
Threshold Current		I_{th}	CW	-	65	85	mA
Operating Current		I_{op}	$P_o=40\text{mW}$	-	110	130	mA
Operating Voltage		V_{op}	$P_o=40\text{mW}$	-	2.4	2.7	V
Lasing Wavelength		L_p	$P_o=40\text{mW}$	-	638	645	nm
Beam ³⁾ Divergence	Perpendicular	Q_v	$P_o=40\text{mW}$	10	16	22	$^\circ$
	Parallel	Q_h	$P_o=40\text{mW}$	6	8	10	$^\circ$
Off Axis Angle	Perpendicular	dQ_v	-	-3	-	3	$^\circ$
	Parallel	dQ_h	-	-3	-	3	$^\circ$
Differential Efficiency		SE	-	-	0.95	-	mW/mA
Monitoring Output Current		I_m	$P_o=40\text{mW}$	0.3	0.6	0.9	mA

1) Initial values 2) All the above values are evaluated with Tottori Sanyo's measuring apparatus

3) Full angle at half maximum

Note : The above product specification are subject to change without notice.

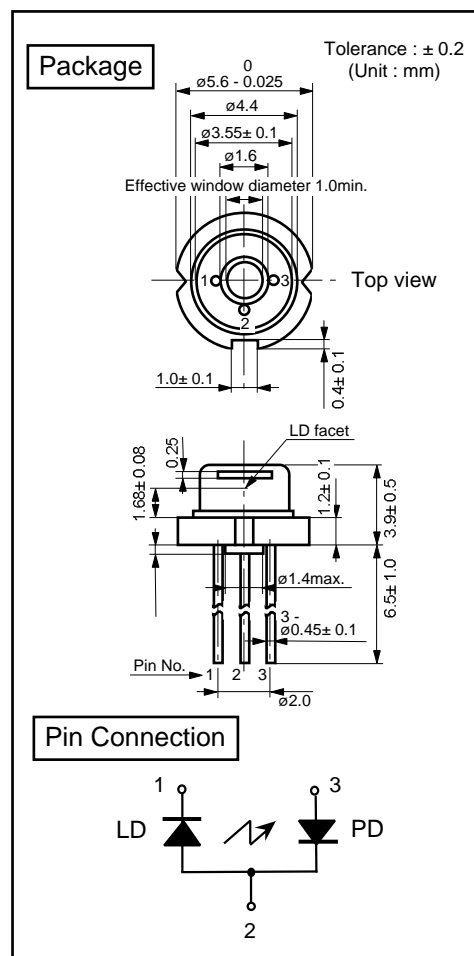

Tottori SANYO Electric Co., Ltd. Photonics Business Unit

5-318, Tachikawa, Tottori 680-8634 Japan TEL : +81-857-21-2137 FAX : +81-857-21-2161

Sales: Creative Technology Lasers USA +1.925.210.1330 Tele +1.925.210.1380 FAX

DL-LS1148



Characteristics

Output power vs. Forward current

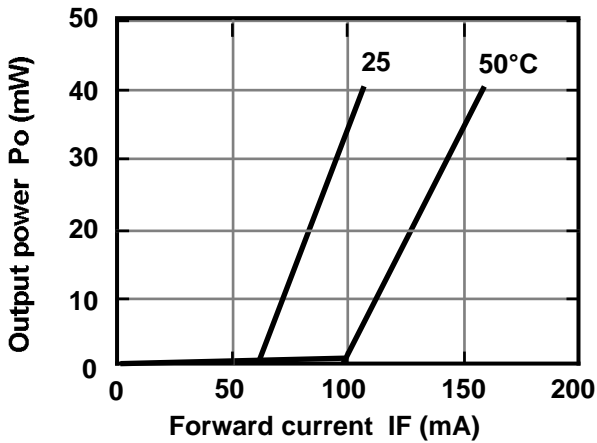

Threshold current vs. Temperature

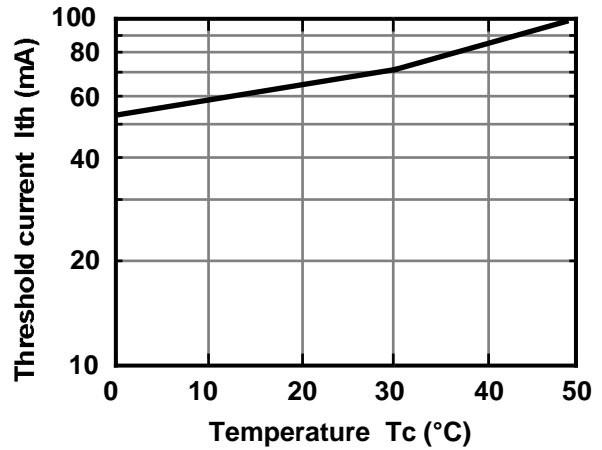

Monitoring current vs. Output power

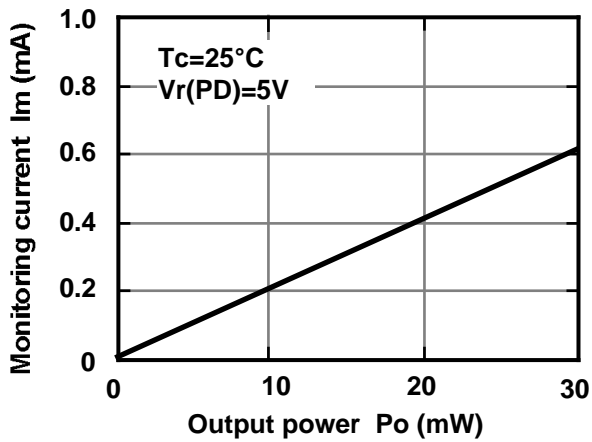

Beam divergence

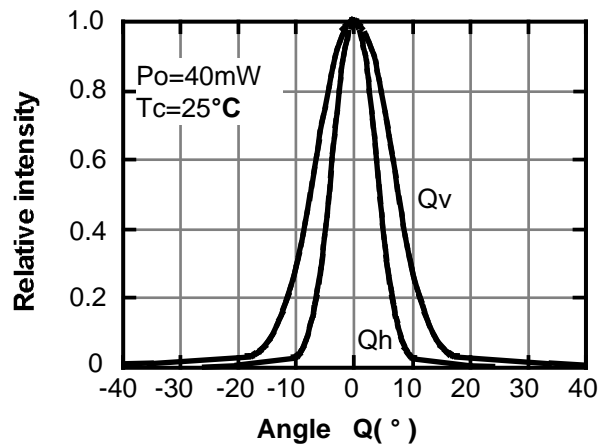

Lasing wavelength vs. Temperature

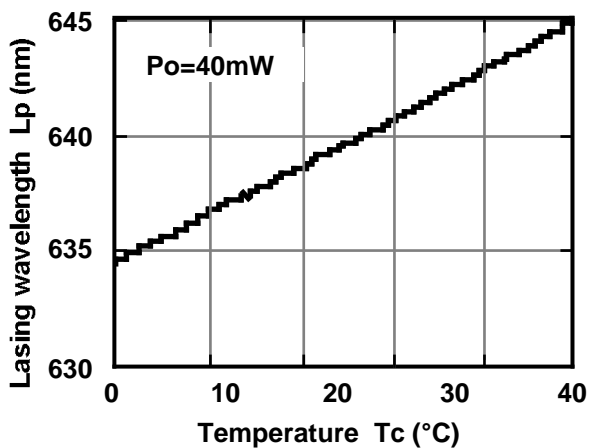

Lasing wavelength vs. Output power

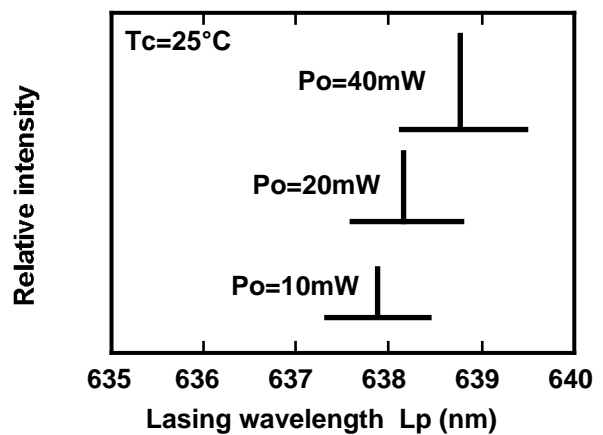

This is typical data and it may not represent all products.